

**ELECTRICAL FEED**

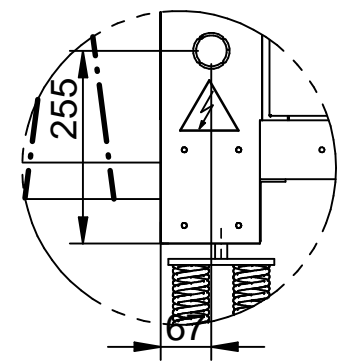

DETAIL A

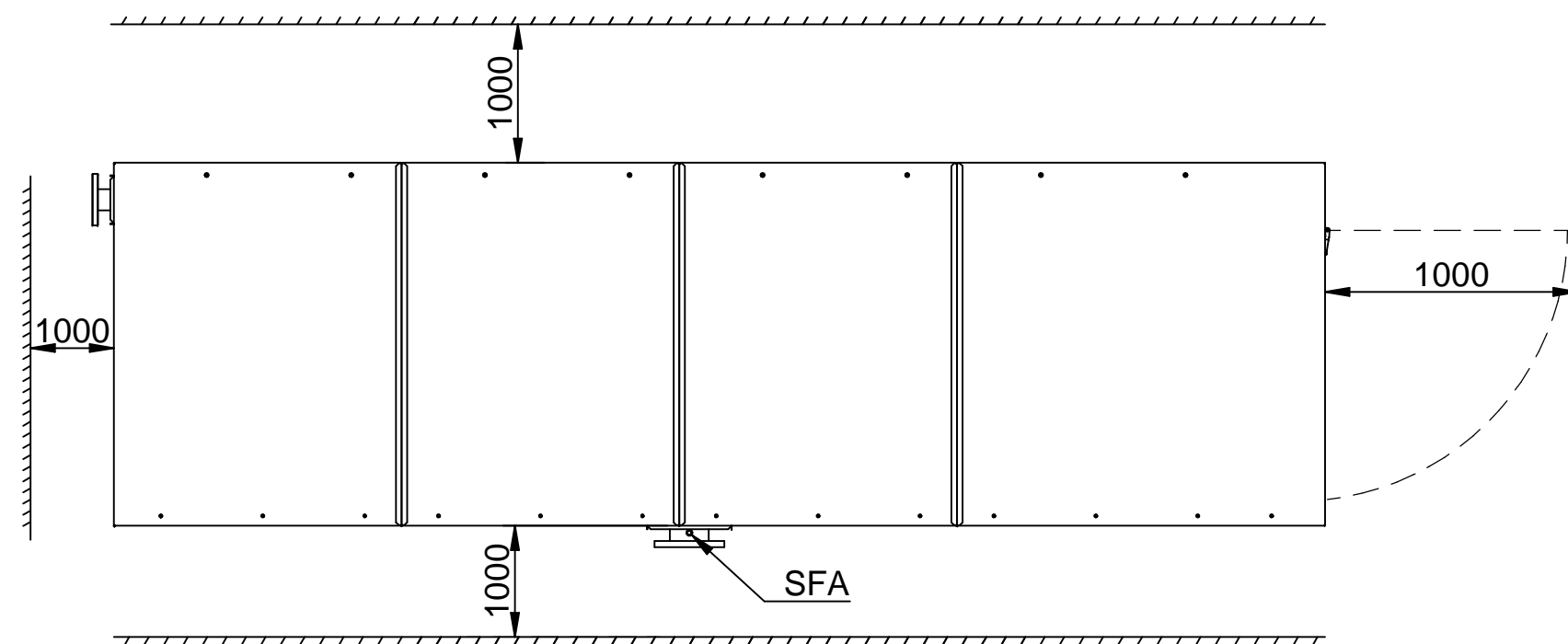

**SAFETY PIN (SAFETY DEVICE)**

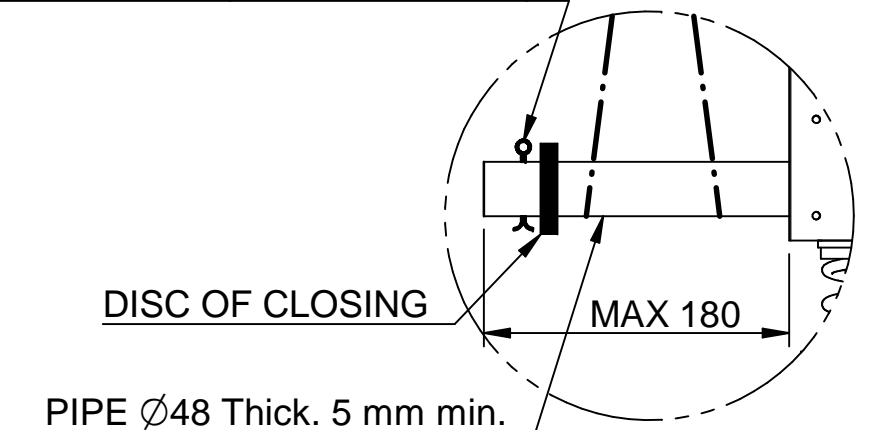

DETAIL B

**LEGEND**

|      |  |
|------|--|
| HPG  | High pressure gauge                      |
| LPG  | Low pressure gauge                       |
| MW   | Water pressure gauge                     |
| RM   | Manual water filling cap                 |
| SFAS | Tank manual air vent                     |
| SFA  | Manual air vent                          |
| VSCS | Tank water drain valve                   |
| ATS  | Spring type antivibrant mounting ( Opt ) |
| ATV  | Rubber type antivibrant mounting ( Opt ) |

**LIFTING AND CARRIAGE PRECAUTIONS**

- Check the weight on the CE label to select appropriate lift equipment .
- Before lifting the unit make sure that the external panel is firmly fixed in place.
- To use only lifting points provided.
- The chains or slings must be of equal length.
- To use a spread-bar to avoid damage to the unit.
- The movement must be performed with caution and avoid abrupt movements.
- Never move the unit on rollers.
- Never lift the unit using a fork-lift.

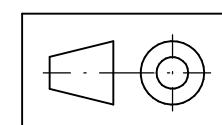

|               |         |
|---------------|---------|
| <b>WEIGHT</b> |         |
| ENW.200 EMPTY | 1930 kg |
| ENW.230 EMPTY | 2210 kg |
| ENW.280 EMPTY | 2270 kg |
| ENW.340 EMPTY | 2730 kg |

|                                       |                     |              |         |                 |
|---------------------------------------|---------------------|--------------|---------|-----------------|
| Scala-Scale                           | Data-Date           | Dis.to-Drawn | N°Pezzi |                 |
|                                       | 23/03/16            | M.M.         |         |                 |
| Peso-Weight Kg.                       | Materiali-Materials |              |         |                 |
| Denominazione-Denomination            |                     |              |         | DIS.-DRAW N.    |
| WATER CHILLER mod. ENW.200÷340        |                     |              |         | DIM-ENW-200ST01 |
| Particolare-Detail                    |                     |              |         | Revisione       |
| OVERALL DIMENSIONS - LIFT INSTRUCTION |                     |              |         | 00              |
| REFRIGERANT R410a                     |                     |              |         | PROGRAM.N.      |