

LEGEND

HPG	High pressure gauge (Opt)
LPG	Low pressure gauge (Opt)
ATV	Rubber type antivibrant mounting (Opt)

MOD.	EMPTY WEIGHT	OPERATING WEIGHT
CFT.061	530 kg	545 kg
CFT.070	560 kg	575 kg
CFT.075	565 kg	580 kg
CFT.090	585 kg	600 kg
CFT.100	670 kg	685 kg

LIFTING AND CARRIAGE PRECAUTIONS

- Check the weight on the CE label to select appropriate lift equipment .
- Before lifting the unit make sure that the external panel is firmly fixed in place.
- To use only lifting points provided.
- The chains or slings must be of equal length.
- To use a spread-bar to avoid damage to the unit.
- The movement must be performed with caution and avoid abrupt movements.
- Never move the unit on rollers.

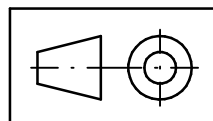

Scala-Scale	Data-Date	Dis.to-Drawn	N°Pezzi	HITEMA [®]
	05/02/09	L.A.	01	
Peso-Weight Kg.	Materiali-Materials			DIS.-DRAW N.
Denominazione-Denomination				DIM-CFT-061ST01
WATER CHILLERS mod. CFT.061÷100				Rev.
Particolare-Detail				03 -M.M.- 03/08/16
Overall dimension - Lift Instruction				PROGRAM.N.
REFRIGERANT R410a				